

## Drone photography summer 2019



Property (193.5 acres) on Blue Star Highway, Covert Township, Van Buren County, MI

**Under existing permit, an estimated 1,700,000 tons of fill sand is available now**

**PERMITTED** The consultants that manage our mining permits have carefully determined that an estimated \$1.7M T of sand is currently available for immediate use (with proper bonding, cell management, etc.) on the Coloma property. This quantity of sand is available entirely from deepening the existing lake to 30 feet and increasing the lake perimeter from 29 to 36 acres (the perimeter that was referenced in the mining permit).

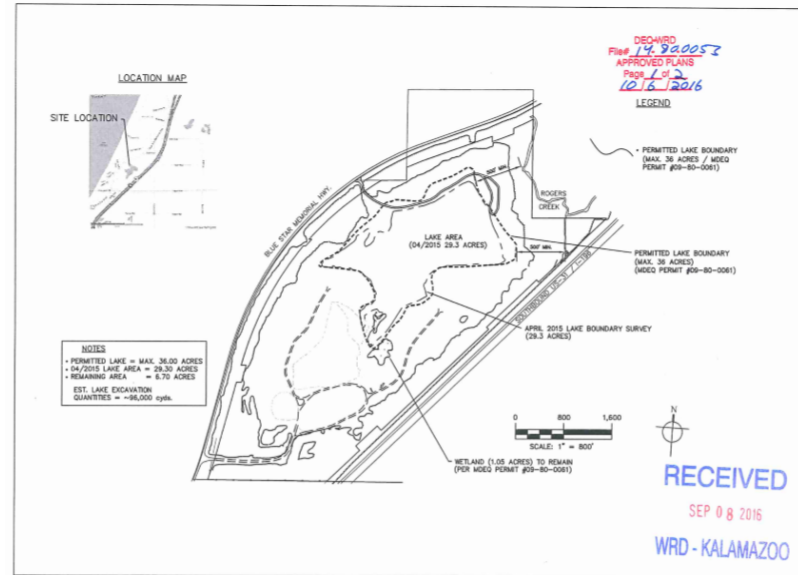

**POTENTIAL** The original mining plan called for a 75-acre lake

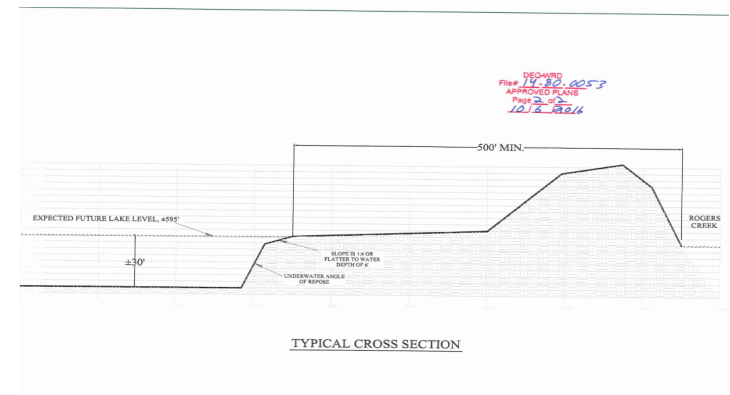
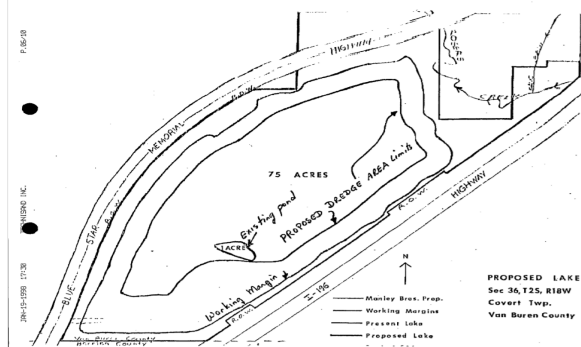

## ***Estimated sand reserves under existing permit***

The estimated volume of material you could excavate under the current permit is the following:

1. 360,000 cu yd (540,000 tons) to clean up the lake and take the bottom to a depth of 30 feet (about 576 elevation). The bathymetry revealed a lot of material still in the bottom of the lake.
2. 336,000 cu yd (504,000 tons) in the expansion of the lake by 7 acres from the existing 29 acres to the permitted 36 acres.
3. 336,000 cu yd (504,000 tons) in the dry excavation of material to an elevation of 610 feet (6' above the lake elevation).
4. If we drop grade another 3' across the south portion of the site (20 acres) and plan on mining only, we gain an additional 97,000 cu yd (145,200 tons)

Total volume available for immediate use (with proper bonding, cell management, etc.) = 1,693,200 tons. In addition, there is potentially a lot of material still available across the property. Utilizing this vast tonnage will require mining permits modifications/approvals or local project approval that include removal of the materials.

**DEQ**

**NOTICE OF AUTHORIZATION**

**Permit Number:** 14-80-0053-P v.1

**Date Issued:** October 6, 2016

**Expiration Date:** October 6, 2021

The Michigan Department of Environmental Quality, Water Resources Division,  
P.O. Box 30458, Lansing, Michigan 48909-7958, under provisions of the Natural Resources and  
Environmental Protection Act, 1994 PA 451, as amended; specifically:

Part 301, Inland Lakes and Streams.

Authorized activity: \_\_\_\_\_

Hydraulically and mechanically excavate \_\_\_\_\_ sand material to expand an existing 23-acre lake to a maximum surface area of 36 acres and a depth of approximately 30-feet, as previously authorized. All work shall be performed in accordance with the attached plans and permit conditions.

To be conducted at property located in: Van Buren County, Covert Township, T02S, R17W, Section 36, Property Tax No. 80-07-086-002-01 & 009-00



# Property Location

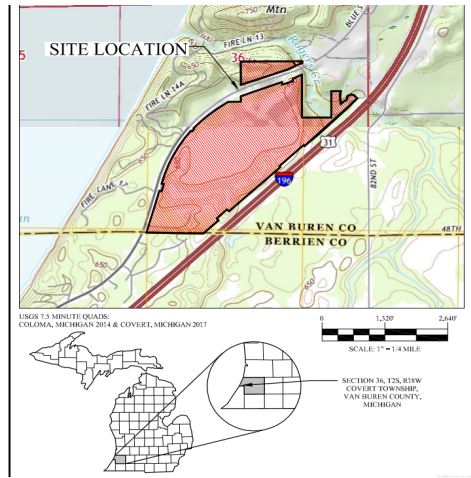
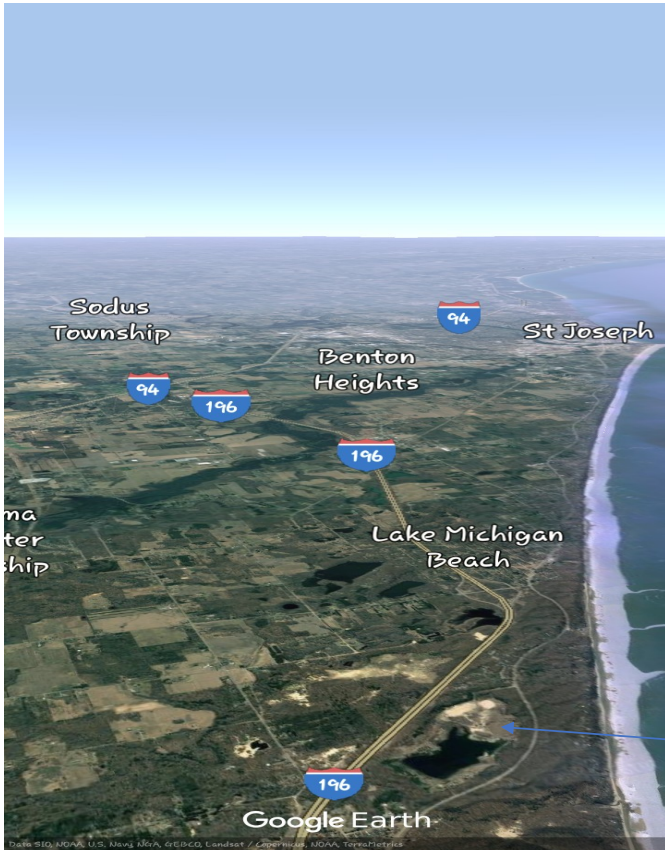



Access to I-196 at Exit 7 is ½ mile south of south gate



## Access and security

*As an operating sand pit for many decades, the property is reasonably secure with only 2 gated entrances*

NORTH GATE



SOUTH GATE



# Aerials, surveys, and topography of the property

