

12.27.2019,  
revised 2.19.2020

## Drone photography summer 2019



Property (193.5 acres) on Blue Star Highway, Covert Township, Van Buren County, MI

**Under existing permit, an estimated 3,000,000 tons of Class II fill sand is available for immediate use now on the Coloma property. Old sieve reports have been located and are available regarding the composition of the sand.**

**PERMITTED The consultants that manage our mining permits have carefully determined that an estimated \$1.7M T of sand is currently available for immediate use (with proper bonding, cell management, etc.) in the lake on the Coloma property. This quantity of sand is available entirely from deepening the existing lake to 30 feet and increasing the lake perimeter from 29 to 36 acres (the perimeter that was referenced in the mining permit).**

**POTENTIAL The original mining plan called for a 75-acre lake**

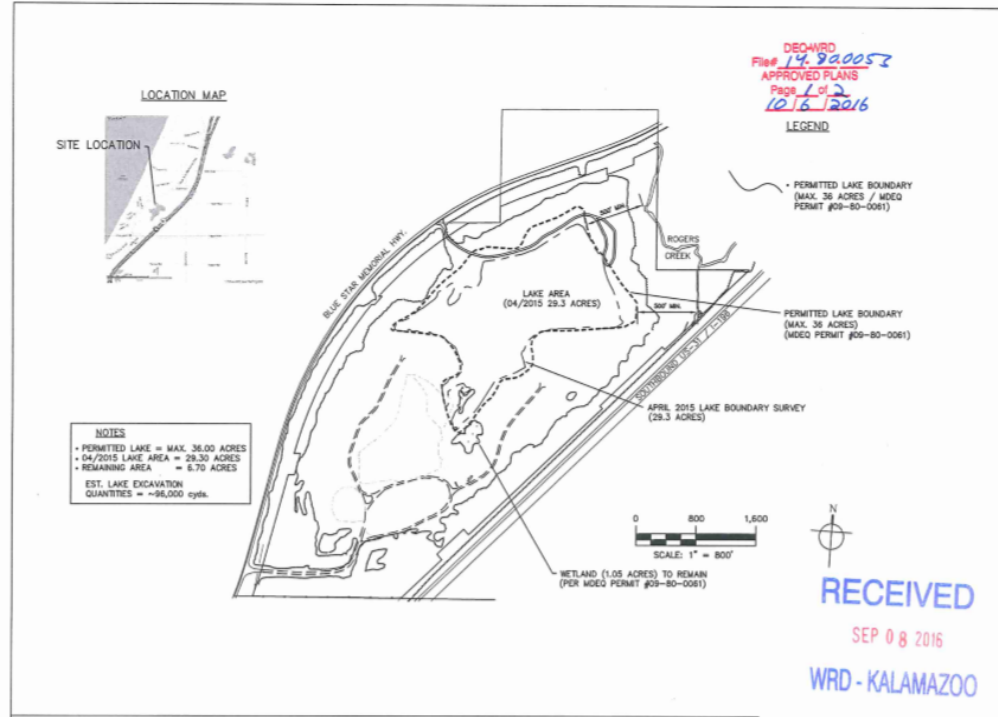

RECEIVED  
SEP 08 2015  
WRD - KALAMAZOO

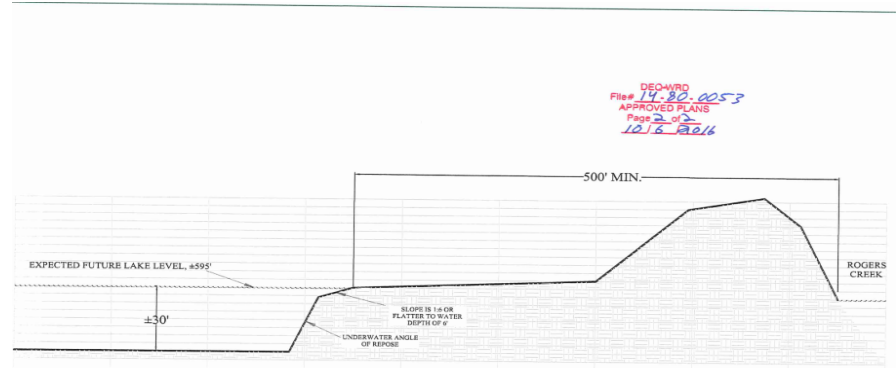
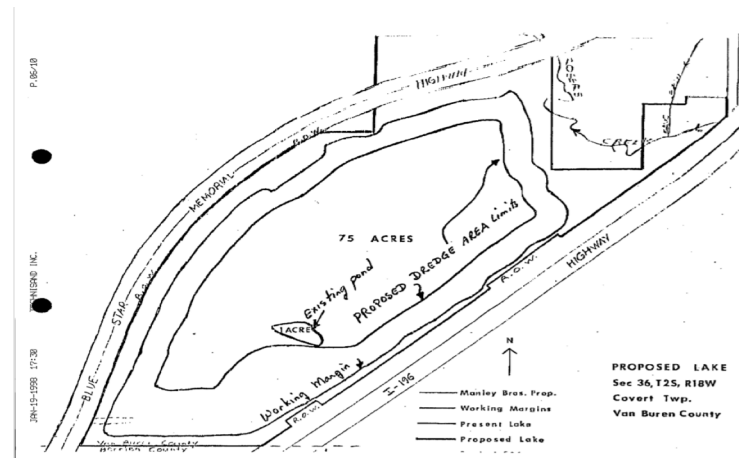

DEQ-WRD  
File# 14-80-0053  
APPROVED PLANS  
Page 2 of 2  
10/15/2016

TYPICAL CROSS SECTION

## ***Estimated sand reserves in the lake under existing permit***

The estimated volume of material in the lake you could excavate under the current permit is the following:

1. 360,000 cu yd (540,000 tons) to clean up the lake and take the bottom to a depth of 30 feet (about 576 elevation). The bathymetry revealed a lot of material still in the bottom of the lake.
2. 336,000 cu yd (504,000 tons) in the expansion of the lake by 7 acres from the existing 29 acres to the permitted 36 acres.
3. 336,000 cu yd (504,000 tons) in the dry excavation of material to an elevation of 610 feet (6' above the lake elevation).
4. If we drop grade another 3' across the south portion of the site (20 acres) and plan on mining only, we gain an additional 97,000 cu yd (145,200 tons)

Total volume available in the lake for immediate use (with proper bonding, cell management, etc.) = 1,693,200 tons.

In addition, there is potentially millions of tons of Class II fill sand still available across the property, mostly lake sand although these reserves will require mining permits modifications or local project approval that include removal of the materials.



### NOTICE OF AUTHORIZATION

Permit Number: 14-80-0053-P v.1

Date Issued: October 6, 2016

Expiration Date: October 6, 2021

The Michigan Department of Environmental Quality, Water Resources Division,  
P.O. Box 30458, Lansing, Michigan 48909-7958, under provisions of the Natural Resources and  
Environmental Protection Act, 1994 PA 451, as amended; specifically:

Part 301, Inland Lakes and Streams.

Authorized activity:

Hydraulically and mechanically excavate [REDACTED] of sand material to expand an existing 23-acre lake to a maximum surface area of 36 acres and a depth of approximately 30-feet, as previously authorized. All work shall be performed in accordance with the attached plans and permit conditions.

To be conducted at property located in: Van Buren County, Covert Township, T02S, R17W,  
Section 36, Property Tax No. 80-07-086-002-01 & 009-00

## Estimated permitted sand reserves on the ground under existing permit

**PERMITTED.** An estimated 1.3M T of sand is currently available for immediate use (with proper bonding, cell management, etc.) on the ground at Coloma property as described on the accompanying map.



# Property Location

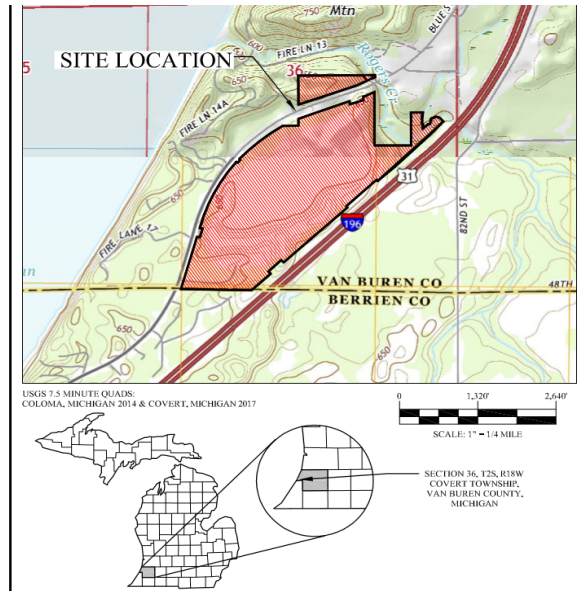
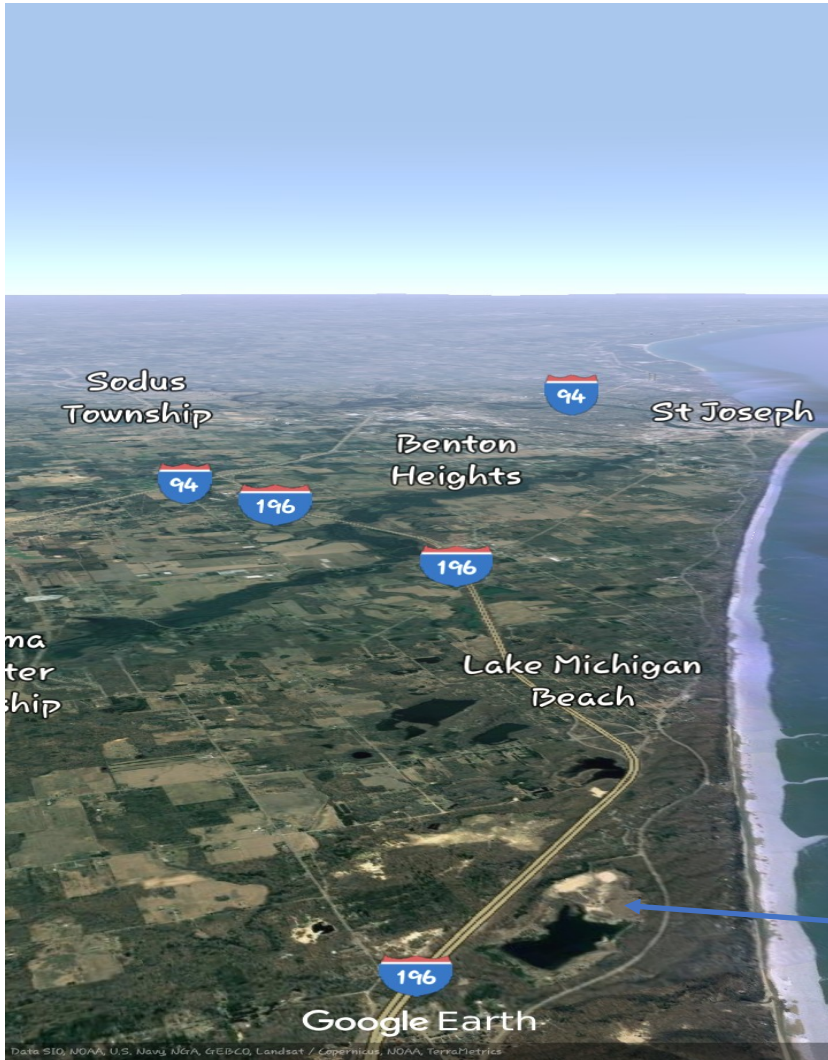

Access to I-196 at Exit 7 is ½ mile south of south gate, and, this route was the used for decades to haul sand to a Bridgman plant location.



# Access and security

*As an operating sand pit for many decades, the property is reasonably secure with only 2 gated entrances*

NORTH GATE



SOUTH GATE

The property is large enough to operate as an aggregate site and a development site for years

